

Edit Date : Jan.2011

Specification

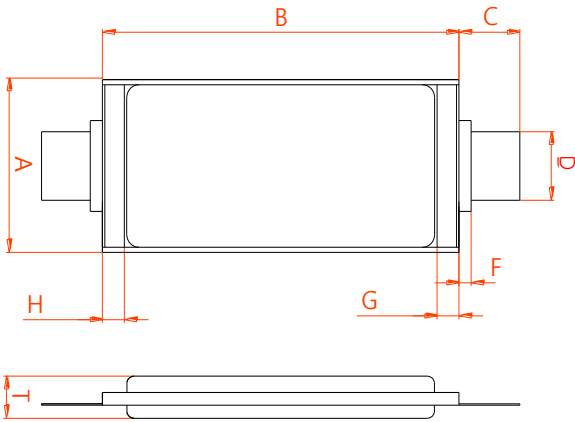

ITEMS	(mm)			
	Cell Dimension	T	10.1 ± 0.2	C
A		43.5 ± 1.0	D	20 ± 1.0
B		127.7 ± 1.0	F	1.0 ± 0.5
Weight	Gram	113 ± 1.5		

TYPE : Li-ion Polymer Battery		PQ5400 LP2
NOMINAL CAPACITY (mAh)		5400(5.4Ah)
NOMINAL VOLTAGE (Volt)		3.7
IMPEDANCE at 1KHz (mΩ)		Max. 5.0
CHARGE	CURRENT (A)	Max. 10.8 (2C)
	VOLTAGE (V)	Max. 4.2
DISCHARGE	CONTINUOUS(A)	97.2 (18C)
	BURST(A)	Max. 145(27C)
	VOLTAGE (V)	Min. 2.8
CYCLE LIFE 70% Retention	1C/1C	500+ cycle
	1C/18C	100cycle
CELL STATUS ON SHIPMENT		Half Charged (3.8V)

Rate Characteristics

PQ5350(5350mAh) 1.0CmA = 5400mA

Charge : CC-CV, 1.0CmA, 4.2V 0.1CmA Cut-off @23°C±3°C

Discharge : CC, 1CmA / 5CmAh / 10CmA / 16CmA, 2.8V Cut-off @23°C±3°C

